

ZB-1307S



DIMENSIONS

UNIT: mm

Tole rance: $\pm 0.5\text{mm}$

Reflow Solderable and Washable

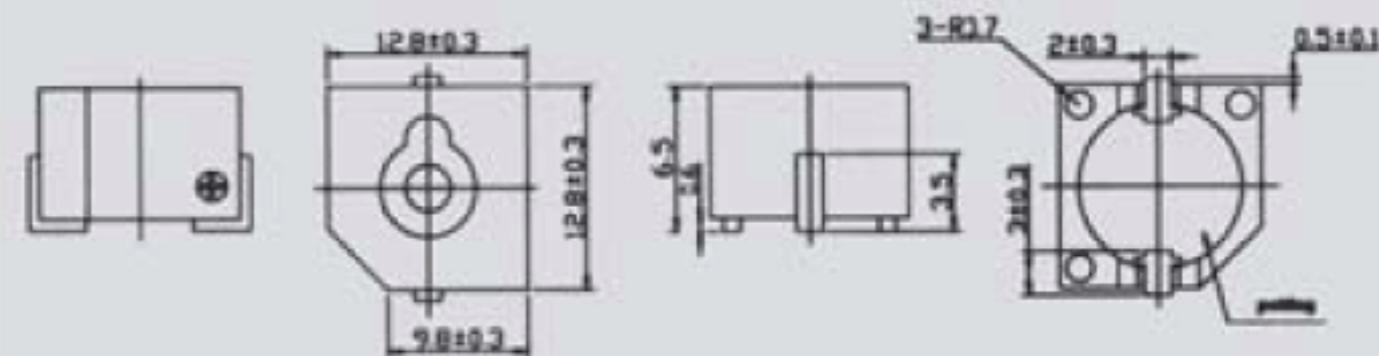

SPECIFICATIONS

Type	Unit	ZB-1307S-03	ZB-1307S-05	ZB-1307S-12
Rated Voltage	V	3	5	12
Operating Voltage	V	2-5	4-7	8-15
*Rated Current(MAX)	mA	30	30	30
*Min Sound Output at 1.0 cm	dB	75	88	85
*Resonant Frequency	Hz	2400 \pm 400		
Lead Pin Material		Brass		

*Value Applying at Rated Voltage(DC)