

ZB-PT-1507T



DIMENSIONS

UNIT: mm

Tolerance: $\pm 0.5\text{mm}$

Reflow Solderable and Washable

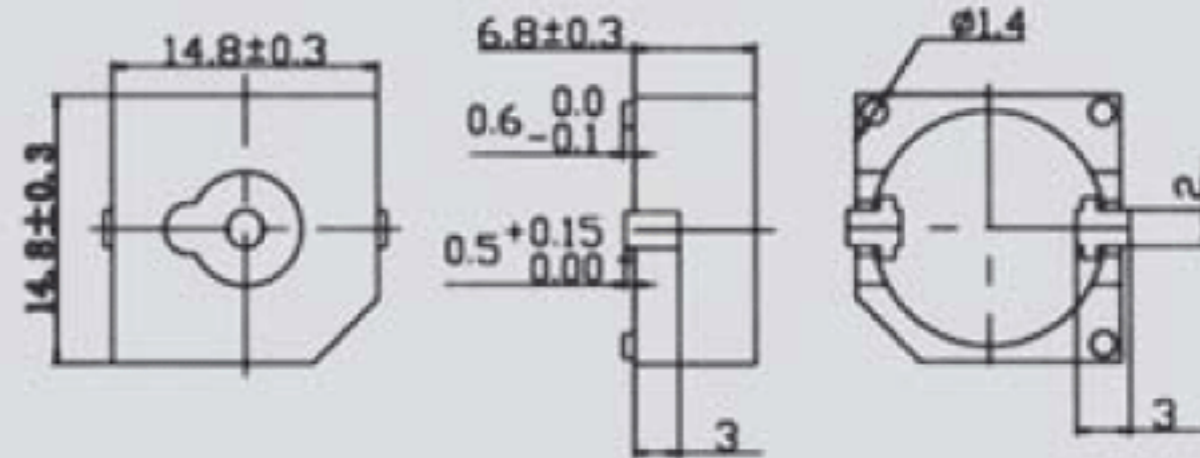

SPECIFICATIONS

Type	Unit	ZB-PT-1507T
Rated Voltage(Square Wave)	Vp—p	12
Operating Voltage	Vp—p	1-20
*Rated Current(MAX)	mA	3
*Min Sound Output at 5KHz / 10 cm	dB	85
*Resonant Frequency	Hz	5000 \pm 500
Capacitance at 120Hz	pF	15000 \pm 30%
Lead Pin Material		Brass

*Value Applying at Rated Voltage(resonant frequency, 1/2 duty, square wave)